

Parcel A
Townhomes
2.17 acres (94,410 SF)
39 Townhouse Units (2.17 A x 18 DU/A)
91 Parking Spaces
Mix of 2-Story and 3-Story Self-Parking Units

Parcel B
Senior Housing
1.57 acres (68,321 SF)
39 Senior Apt. Units (1.57 A x 30 DU/A)
26 Parking Spaces
2-Story Apartment Buildings Over 1/2 level Parking Below

Parcel C
Multi-Family Housing
3.39 acres (147,622 SF)
136 Apt. Units (3.39 A x 40 DU/A)
316 Parking Spaces
3-Story Apartment Buildings Over 1/2 level Parking Below



SPRR - DUMBARTON BRANCH

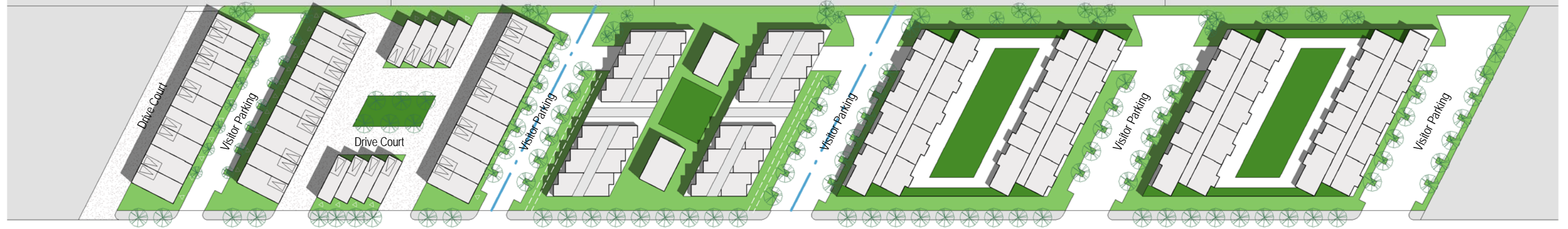

Hamilton Ave

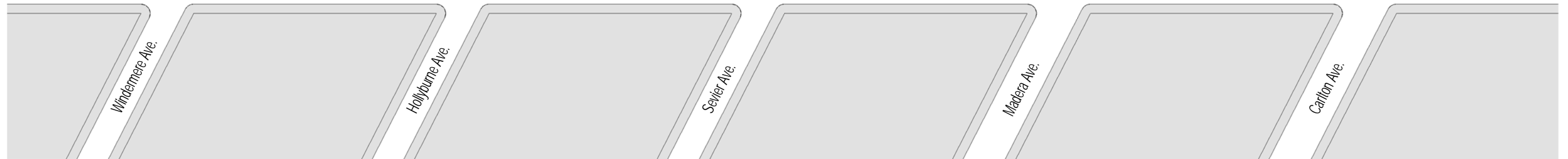

Parcel Dimensions

Parcel A:	2.16 A	39 Townhouse Units
Parcel B:	1.57 A	39 Senior Housing Units
Parcel C:	3.38 A	136 Multi-Family Units
Total:	7.11 A	214 Units Total

